

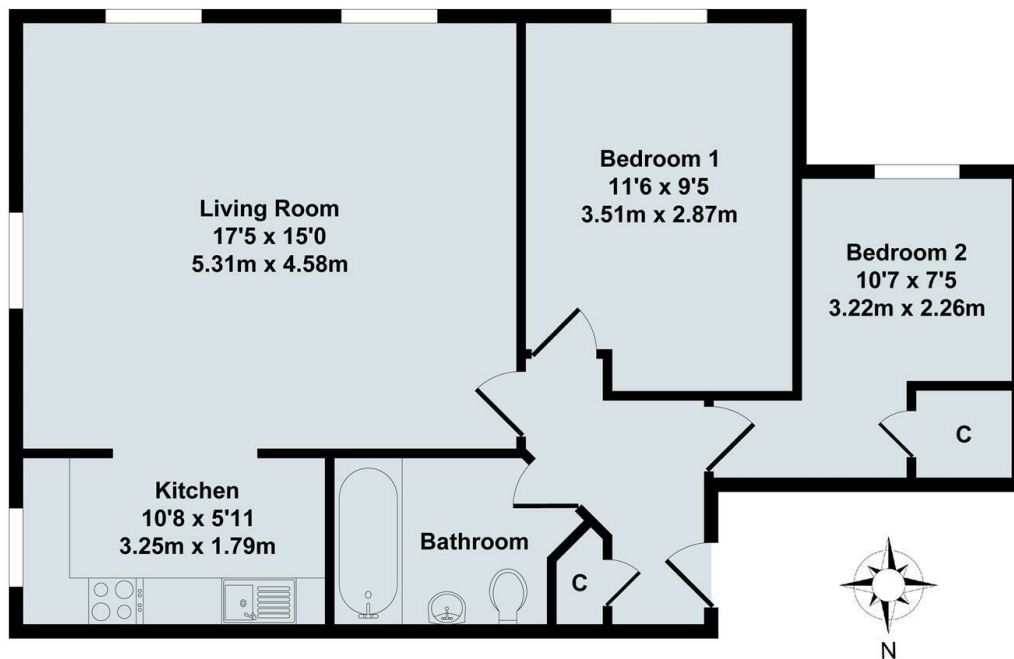

166 Jackman Close, Abingdon, OX14 3GA

£1,350 Per Month - 20th January 2026.

- Situated on this popular development, a large two bedroom 2nd floor unfurnished flat.
- Fully fitted Kitchen with electric cooker, fridge and washing machine
- Council Tax Band C
- Located within walking distance of the town centre
- Electric Heating
- 643 SQ FT
- Car port with shed and allocated parking
- EPC Rating D
- Spacious living room



Total Approx. Floor Area 643 Sq.Ft. (59.70 Sq.M.)

All items illustrated on this plan are included in the "Total Approx Floor Area"

Directions

Viewings

Viewings by arrangement only. Call 01235 554950 to make an appointment.

Council Tax Band

C

EPC Rating:

C

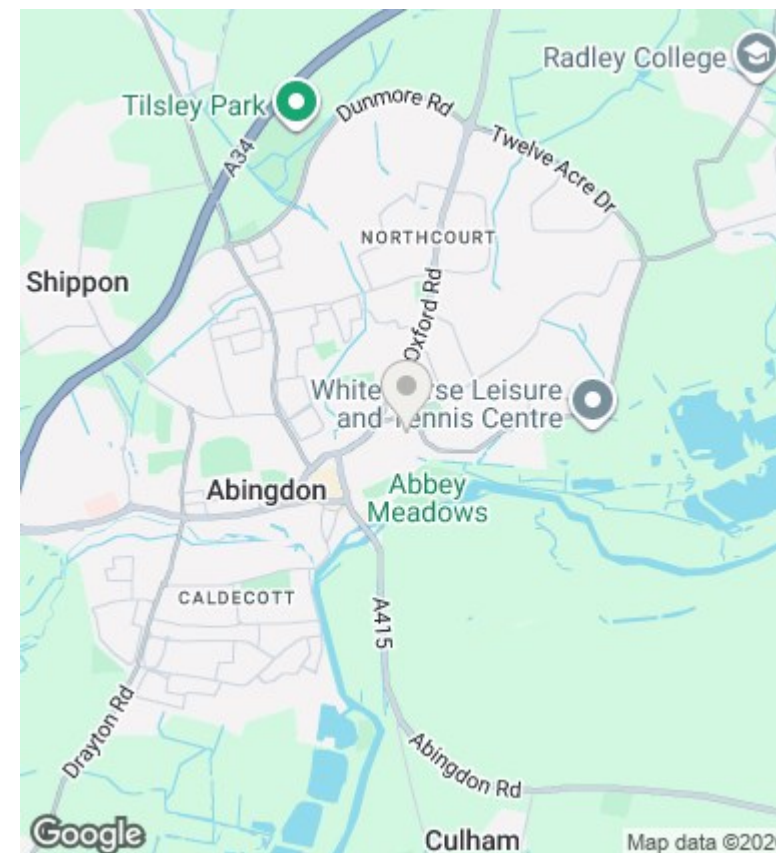

Energy Efficiency Rating		
	Current	Potential
Very energy efficient - lower running costs		
(92-plus) A		
(81-91) B		
(69-80) C	80	81
(55-68) D		
(39-54) E		
(21-38) F		
(1-20) G		
Not energy efficient - higher running costs		
England & Wales	EU Directive 2002/91/EC	